

Learn by Reading Pictures, Easy Operation!

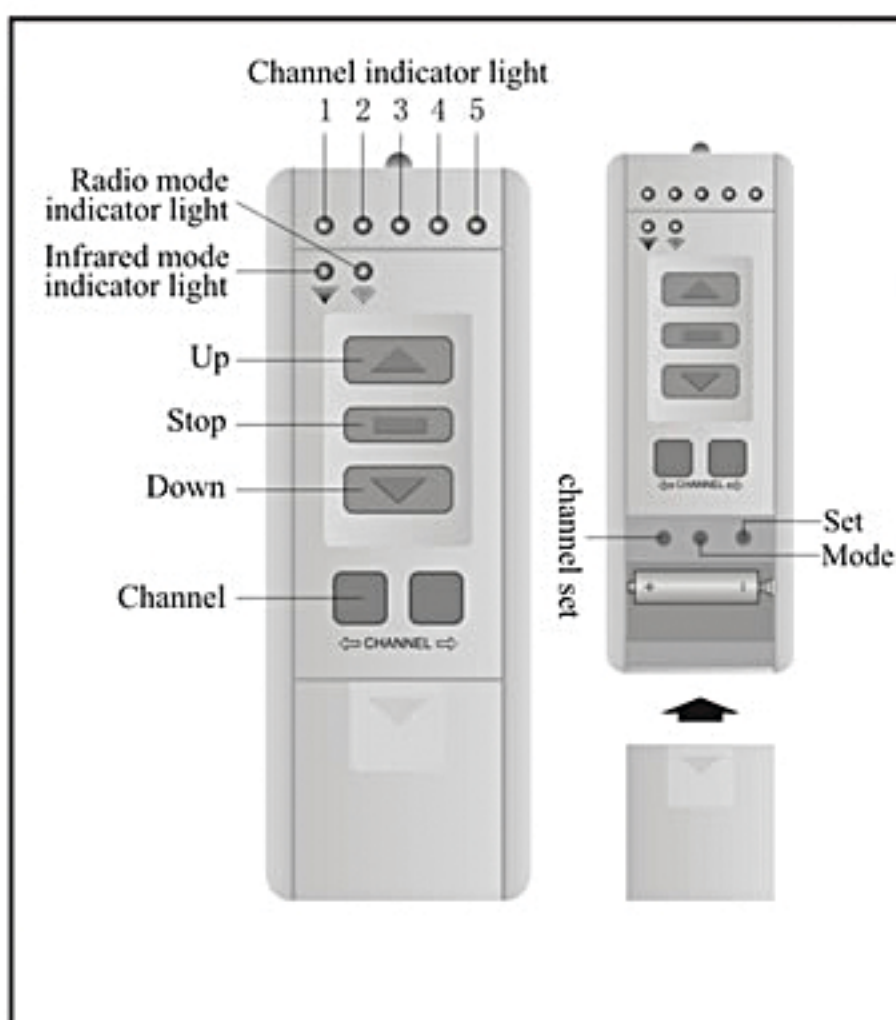

I. Enter into setting state

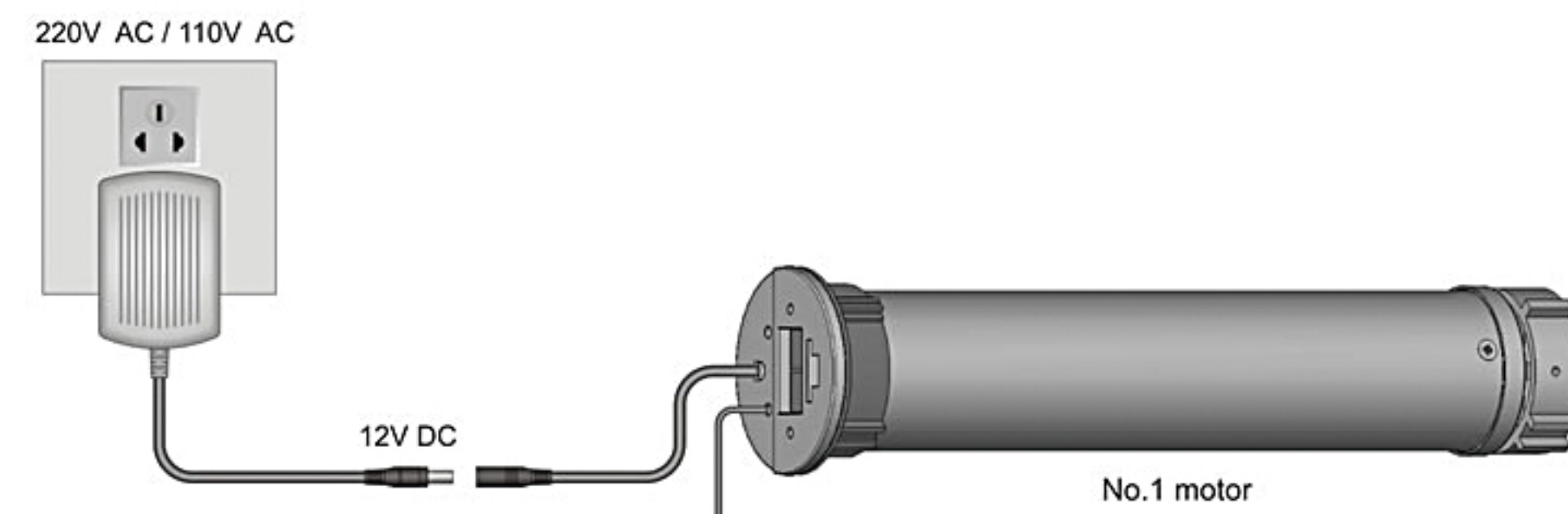

Connect up power , there will sound a long whistle.

Remarks: Please complete the next step within 20 seconds, or the motor will be out of setting state automatically. In this condition, you should cut off power for more than 30 seconds, then connect up power, it will re-enter into setting state when there sounds a long whistle.

II. Channel setting steps of remote controller

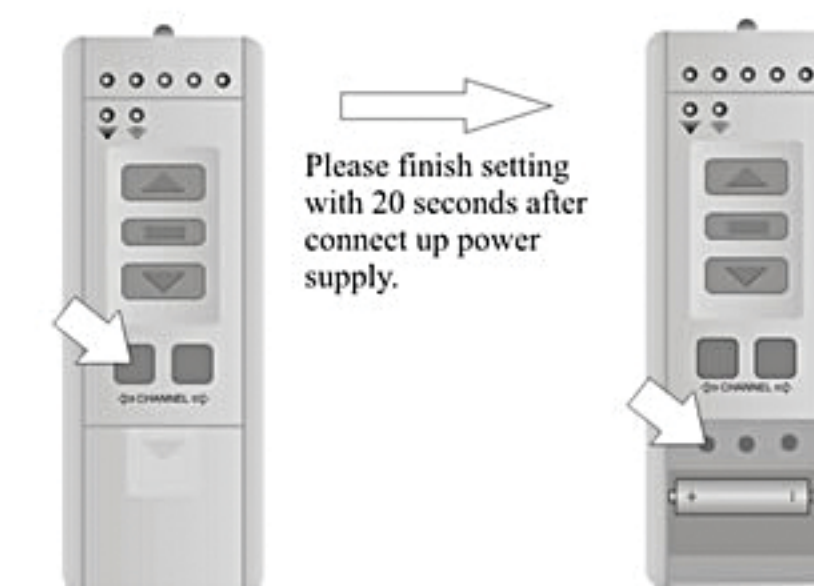

1. Press left/right channel button to turn channel 1 light on(or any channel that you like)

2. Press channel set button, channel 1 setting will finish when there sound a long whistle.

III. Position (up or down) setting steps

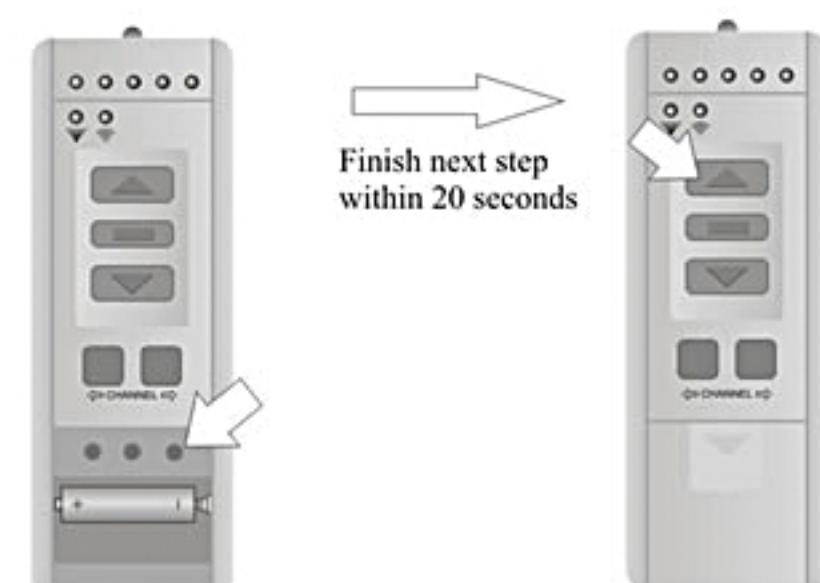

1.Press SET button for 5 seconds, then loose SET button when the sound changes from short whistle to long whistle. At this time, the motor will turn into the setting state.

2. Press UP button to let motor move to the upwards that you like.

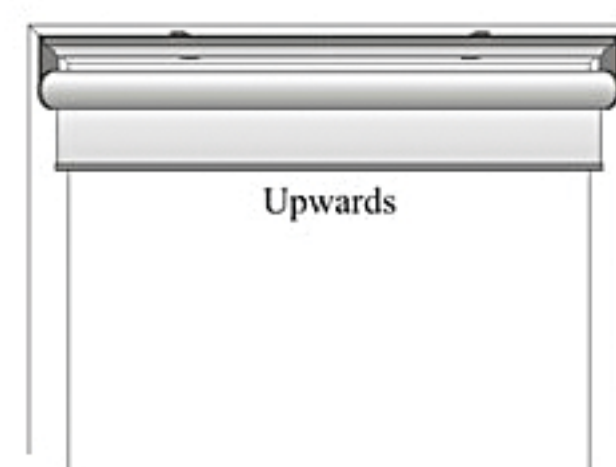

3. Press STOP button when motor move to the upwards that you like.

4. Press STOP button firstly, then press UP button at the same time. Loose two buttons when there sounds a long whistle, then upwards setting has been finished.

5.Press DOWN button to let motor move to the downwards that you like.

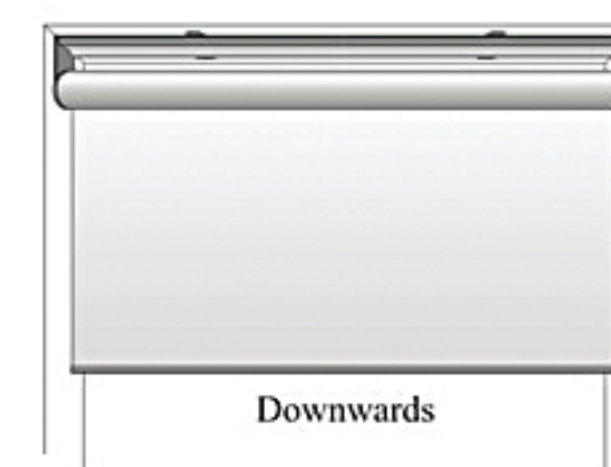

6.Press STOP button when motor move to the downwards that you like.

7. Press STOP button firstly, then press DOWN button at the same time. Loose two buttons when there sounds a long whistle, then downwards setting has been finished. At this time, all the settings are over.

Remarks:

1. All the above operation, interval time shouldn't exceed 20 seconds, otherwise the motor will be out of setting state automatically. So it need to reset according to the above steps.

2. During the operation, if make some mistakes carelessly, please cut off the power supply for more than 30 seconds firstly, then connect up. When there sounds a long whistle, reset according to step 1-7.

IV. Setting steps for the same remote controller to control another motor.

1、Set channels:

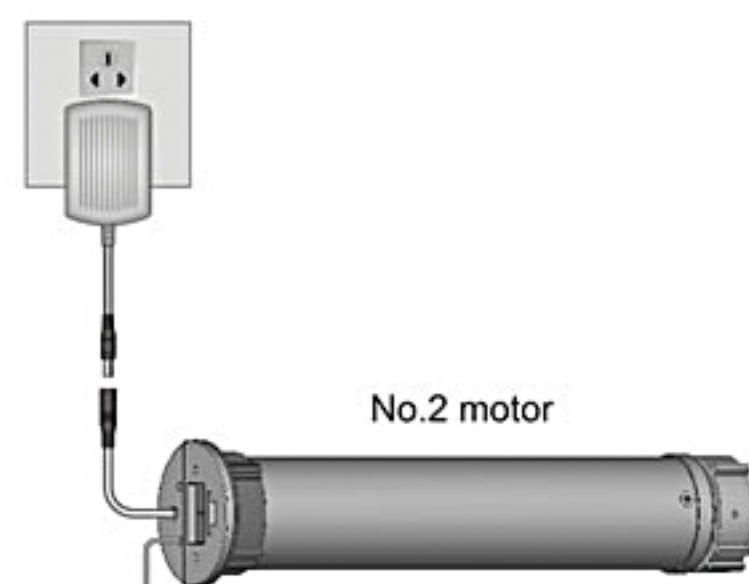

(1) Please connect up the power supply of No.2 motor after 30 seconds when the No.1 motor's setting has finished.



(2) Press LEFT/RIGHT CHANNEL buttons to turn channel 2 light on. (or other channel lights that you like)



(3) Press CHANNEL SET button, the setting is finished when there sounds a long whistle.

2、Set positions The setting steps are just the same as Step III.

Remarks:
If choose the same channel as No. 1 motor, it needs to cut off No.1 motor firstly.

V. Please check the mode of remote controller before usage. (It is set in radio mode before out of factory.)

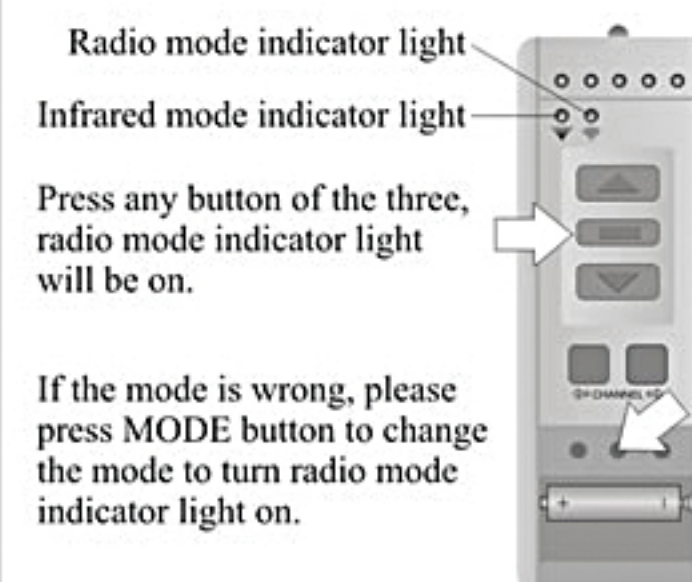

VI. The way to change the direction of motor.

Before set position, please make sure whether the upwards or downwards position are the same as the buttons on the remote controller.

Press UP and DOWN positions at the same time, loose two buttons when there sounds a long whistle. Then the position is changed.



Remarks:
If the positions are changed after the position is set well, you should to reset it once again.

VII. The way to clear the channels set before.

Please cut off power for 15 seconds,then connect up and finish the following operations when there sounds a short whistle.

Press STOP and CHANNEL SET buttons at the same time, loose the two buttons when there sounds a long whistles. Then the channels set before are cleared up.



Remarks:
If to continue to use remote controller, the ways are as Step II.

VIII. Multi-controlling function operation.

Press LEFT and RIGHT CHANNEL buttons at the same time, all the indicator lights will be on. Under this condition, it can control 5 sets of motors up, down or stop at the same time.

